



Polished Chrome

The integrity of solid brass plated in highly polished chrome for a stunning mirror smooth finish lends authenticity to modern retro designs and futuristic high tech settings.

Satin Nickel

The perfect design solution for applications when both silver tones and an aura of understated sophistication are needed.

Oil-Rubbed Bronze

A finish that starts its long life with a matte black appearance blooms, with time and handling to reveal subtle bronze highlights that suggest they have been centuries in the making.

Description



- Two Handle Lavatory Faucet
- Water Saving 2.2 GPM Aerator (1.5 GPM Available)
- Solid Handle (ADA), with Escutcheon
- Plastic Base Plate (Finished)
- ½" IPS Connector, without Supply Nut
- NSF 61-9 Certified / AB-1953 Compliant

Model:
WL-HL-307700-ZZ

Compliance

- Complies with the requirements of CUPC
- Complies with NSF
- Complies with AB1953
- Complies with ASME

Warranty

- Limited Lifetime Warranty

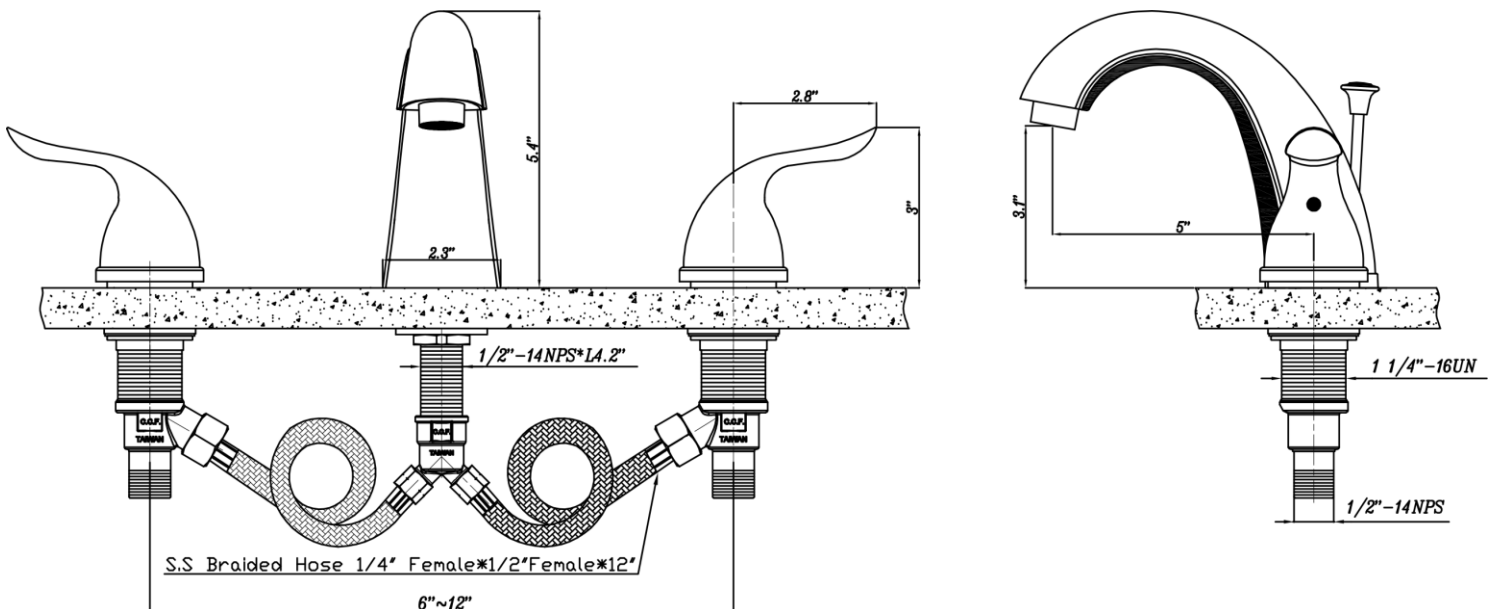

Lavatory Widespread



Model: WL-HL-307700-ZZ

Available Finishes

Chrome (CP)
Satin Nickel (SN)

Standards



- IAPMO UPC/CUPC
- NSF 61-9

MEETS ASME
A112.18.1

- ASME A112.18.1

MEETS
CA AB-1953

- CAAB-1953



- ADA Accessibility Guidelines

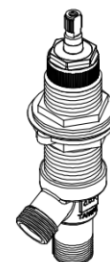
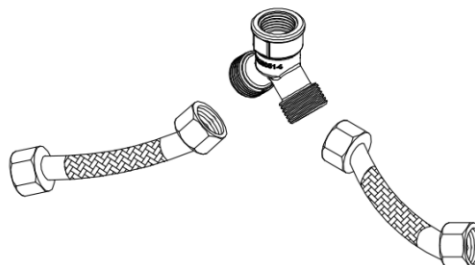
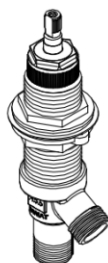
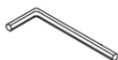
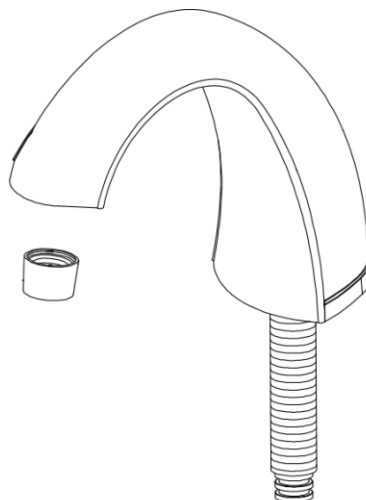
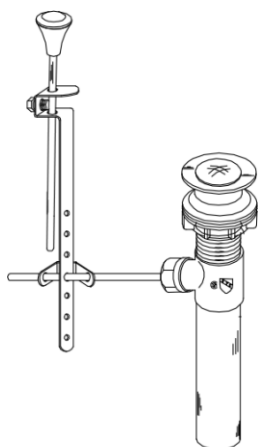

Instruction Sheet

Please read carefully before installation.



Model Number:

WL-HL-307700-CP

WL-HL-307700-SN

WL-HL-307700-OB

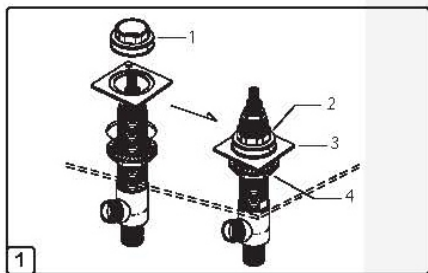

Install Valve bodies (MAKE SURE the main water supply is completely turned off):

To install the valve bodies first loosen the bottom lock nut on the neck of the valve such that the valve has enough room when placed through the hole from under the counter top. Next, place the handle flange over the valve body. Then, screw the top lock from the handle base on to the valve body, screw the lock nut down until it stops. Position the valve body and the trim flange as desired. Tighten the bottom lock nut until valve body is secure.

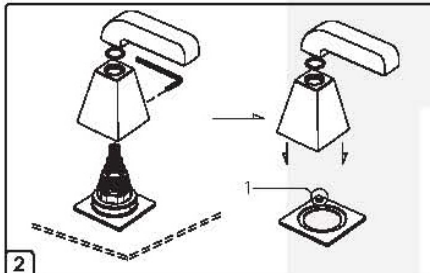

Install Handle Trim:

Place the handle base over the valve stem and slide it onto the lock nut positioning the pin into the hole. Next, place the handle base over the stem and turn the handle into the off position (pointing left for the hot side and pointing right for the cold side). Place the handle tip onto the valve stem in the desired position. Tighten and secure the handle tip with the set screw on the under side (or the back side) on the handle tip. Repeat for the other side.

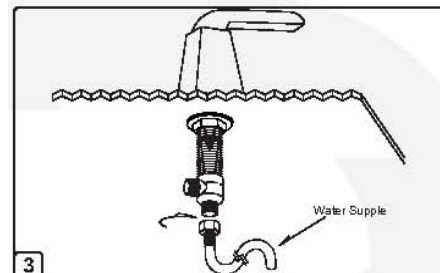

Install Water supply:

Connect the water supply hoses from the angle stops in the wall to the bottom inlets of the hot and cold valve bodies. There are various types of connections that can be used. The most common installation used is to use the existing flexible copper line with a cone washer and coupling nut.

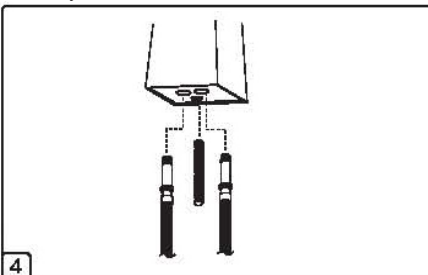

Assembling the spout:

Before mounting the spout onto the counter surface, first install the water supply flex hoses into the inlets on the bottom of the spout. Please note that Canpolar Hardware carries different types of water supply flex hoses. The photo is just for reference use.

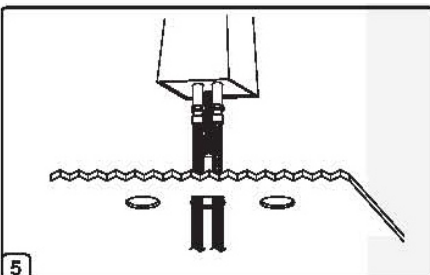

Installing the spout:

Now you are ready to install the spout into the counter surface. First, slide the flex hoses through the center hole in the counter top. Place the spout over the hole and the mounting bolt down into the center hole. Center the spout over the hole and adjust the position such that the spout is an even distance from both handles.

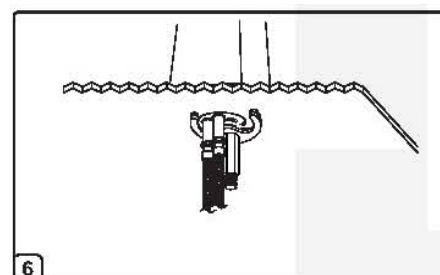

Installing the spout:

Next, from underneath the counter surface slide the U shaped washer and mounting bracket onto the mounting bolt. Position the mounting bracket and washer so that the flex hoses run through the middle of the bracket. Adjust spout to the desired position and tighten the mounting nut onto the bolt until the spout is secure.

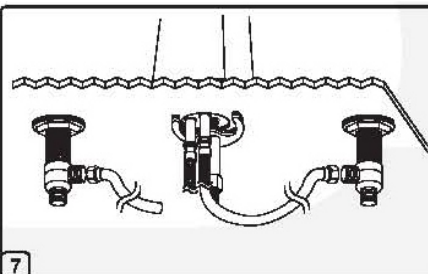

Connect the water supply hoses:

Connect the water supply hoses from the bottom of the spout to the side outlets of the hot and cold valve bodies. Screw the hex nut of each supply hose to the connection of the side of the valve body. Screw the nuts down until hand tight and add an extra 1/2 turn with a wrench. (Do not over tighten.)

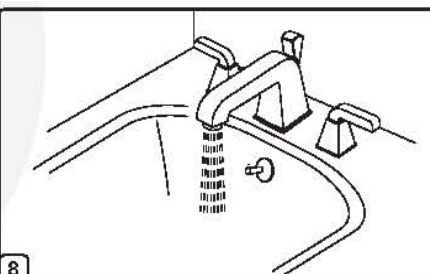

Flush and Check:

After installation is complete, turn on the main water supply. You will need to flush the system and inspect all connection areas to make sure there are no leaks. To flush the system first remove the aerator. Turn on both hot and cold water for about 2-3 minutes. While water is running check for any leaks above and below the counter surface.