

Farmhouse Kitchen

Features

- Crafted from high-quality Fireclay Ceramic
- Farmhouse Kitchen Style
- Dual Compartment
- Rectangular Bowls
- Reversible dual-mount showing either smooth or notched front



Dimensions

Outer: 35-3/4" x 18" x 10"
Left Bowl: 18-1/4" x 15-1/4" x 8-1/2"
Right Bowl: 13-3/4" x 15-1/4" x 8-1/2"

Model	Description	
5121	Reversible Dual Bowl Farmhouse Kitchen	

Included Components

- Cut-out template

Available Colors

White

Optional Accessories

- Grid
- Drain
- Specialized Heavy-Weight Mounting Clips

Product Specification

The farmhouse kitchen sink shall be 35-3/4" in width and 18" in length, with each side having an overall depth of 10" and a bowl depth of 8-1/2". Sink shall be a dual compartment with rectangular bowls, composed of Fireclay Ceramic. Sink shall be dual-mountable. Sink shall be Romano Italian Model 5121.

TECHNICAL INFORMATION

Fixture*	
Basin Area (Left Bowl)	18-1/4" x 15-1/4"
Basin Area (Right Bowl)	13-3/4" x 15-1/4"
Water Depth (Left Bowl)	8-1/2"
Water Depth (Right Bowl)	8-1/2"
Drain Hole (Each Bowl)	3-5/8" dia.
*Approximate measurements for comparison only.	



Smooth Front



Notched Front

Front View

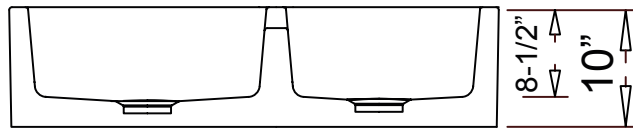

Top View

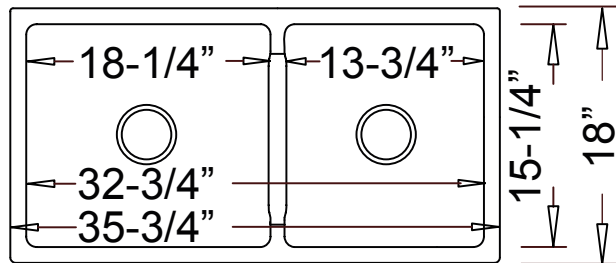

Product Diagram