



## Specification Sheet

# PADB26 - "Georgian"

### Features

- Certified 304 Grade 23 Gauge Stainless Steel
- Drop-In Style
- ADA-Compliant  
(when installed according to ADA mounting guidelines)
- Single Compartment
- Rounded Bowl
- Lustrous and enduring finish which compliments any decor.
- Limited lifetime warranty.

### Drop-In Kitchen



--- Dimensions ---  
 Outer  
 15" x 15" x 5-1/2"  
 Inner  
 12" x 10" x 5-1/2"

Model	Description	Colors / Finishes
PADB26 "Georgian"	Undercounter Sink	N/A

### Included Components

- Mounting Clips
- Cut-out template

### Colors / Finishes

- N/A None Applicable

### Optional Accessories

- Standard Strainer
- Premium Strainer

### Codes / Standards Applicable

Specified model meets or exceeds the following:

- UPC Certified
- ASME Certified
- CSA Certified



### Product Specification

This ADA-Compliant drop-in sink shall be a single compartment with rounded bowl. It shall be 15" in length and 15" in width, with a bowl depth of 5-1/2". Sink shall be made of certified 304 grade 23 gauge stainless steel. Sink shall be ADA-Compliant when installed according to ADA mounting guidelines. Sink shall include installation hardware. Sink shall be Patriot Model PADB26, "Georgian".

# PADB26 - "Georgian"

## TECHNICAL INFORMATION

Fixture*	
Basin Area	12" x 10"
Water Depth	5-1/2"
Drain Hole	3-5/8" D

\*Approximate measurements for comparison only.



Product Image

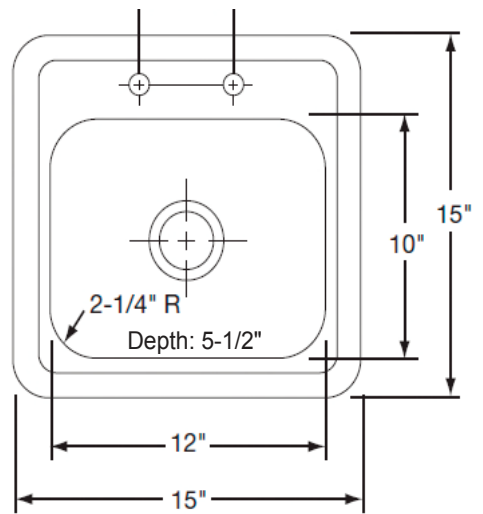

Product Diagram